

# MicroNX

- 300D  
- 300S

Reference for safety/

Please read this reference carefully and use this unit properly. Reference is for keeping safety and preventing damage of property.

## USER'S MANUAL

### Components

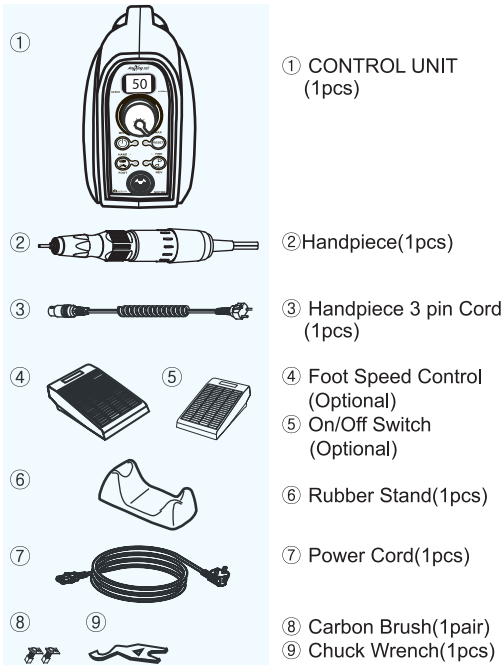

### Reference for safety

#### Installation

- Do not install on unstable location.
- Please keep all vents opened
- Do not install in a location where exposed a direct ray of light.
- Please use in a place where temperature is from 0 degree to 40 degree centigrade.
- Please don't use in high temperature and humidity or in the dust.

#### While working

- Do not drop or shock while motor rotating.
- Do not leave a motor being turned on.
- Do not turn off power switch when motor is on.
- Please wear protective goggles to prevent eyes when cutting or grinding.

#### Others

- Please prevent the machine from coming food and other substances.
- Do not drop alcohol or benzene as there is fire danger.
- Do not assembly, repair, modify recklessly.

### Warning/Notice

- Warning** This mark is used when user's misusing can cause death or severe injury
- Notice** This mark is used when user's misusing can cause a property loss

### Part name

#### Front

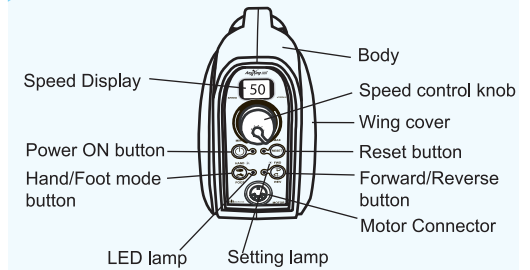

#### Rear

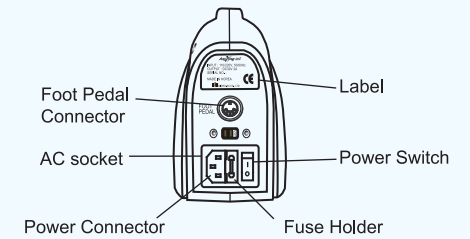

### Electric power

AC 110~220V, 50/60Hz

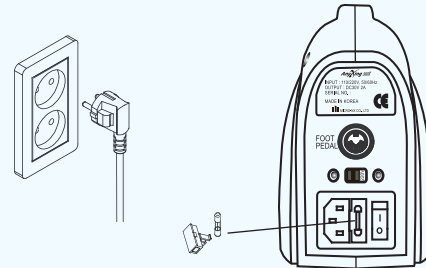

#### Main Power

- Please insert power cord to outlet after confirming AC 100~120V 50/60Hz or AC 200~240V 50/60Hz.
- This unit is set with AC200~240V 50/60Hz when taking goods out of the company.

- Fuse Specification**  
- 250V 3A

### Electric connection

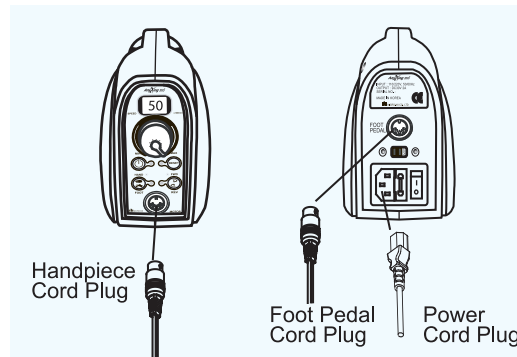

- Please connect the handpiece cord plug to motor connector of control unit after confirming direction.
- Please connect the foot-pedal plug and power cord on rear of control unit after confirming direction.

### Notice

After connecting all cords, please check safety and then insert power cord to outlet.

### Specification

#### Control Unit

REF NO.	INPUT POWER SOURCE	MAXIMUM LOAD CURRENT	OUTPUT POWER SOURCE	POWER	FUSE	WEIGHT	DIMENSION (mm)		
							W	D	H
Anyxing-300D	110/220V 50/60Hz	2.5A	DC 0-32V	120 W	250V 3A	2.2KG	81	222	166
Anyxing-300S	110/220V 50/60Hz	2A	DC 0-32V	100 W	250V 3A	1.8KG	78	222	166

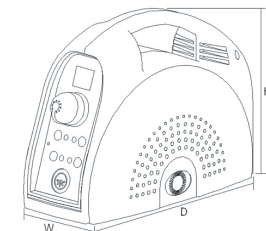

## How to operate the control box

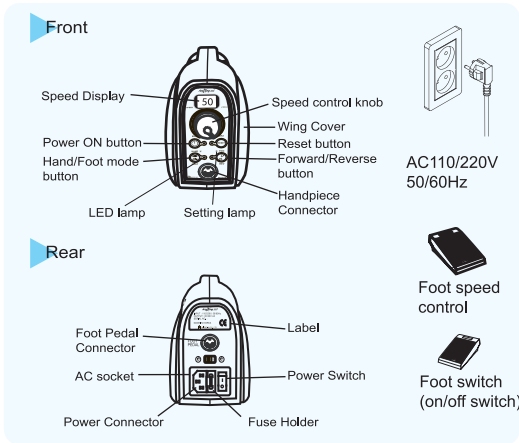

### How to start

- Please confirm that the switch is turned off.
- Please turn the speed control knob at zero.
- Please insert power supply cord into an outlet.
- Please turn on the power switch on the rear.
  - Initial function configuration
  - \* FWD/REV mode : FWD mode (LED is being "ON")
  - \* Hand/Foot mode : Hand mode (LED is being "ON")

### How to use "Hand mode"

- Please set up the direction of motor rotation by putting FWD/REV button.
- Please turn the speed control knob to the right -handed screw. Then set up the needed speed .
- When you need to stop the motor or to reduce rotation speed, turn the speed control knob to the left-handed screw.

### How to work 'Foot mode'

- Please turn the speed control knob at zero.
- Please put Hand/Foot mode button. (LED is 'Off' when 'Foot Mode')
- Please set up the needed speed by the speed control knob.
- When you step on the foot pedal, the motor rotate.



#### Notice

- Using for a long time at maximum rotation speed can shorten the life time of handpiece and control unit.
- Please turn off the power switch after confirming the motor stop completely.
- In the case of not using handpiece for a long time, please disconnect the power cord from the outlet.

### Replacement of "Carbon Brush"

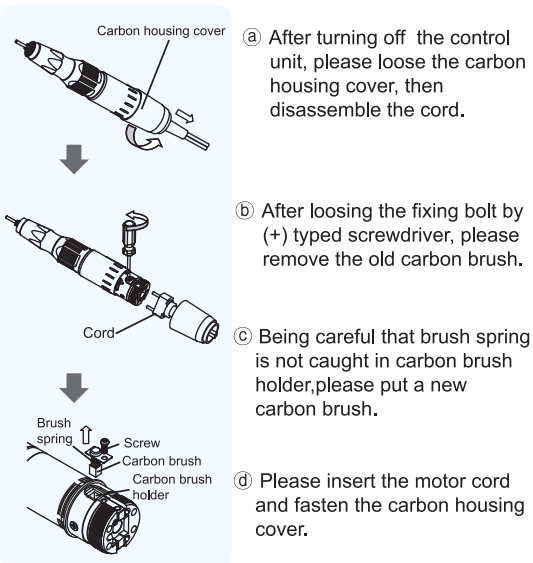

### Replacement of the ball bearing.

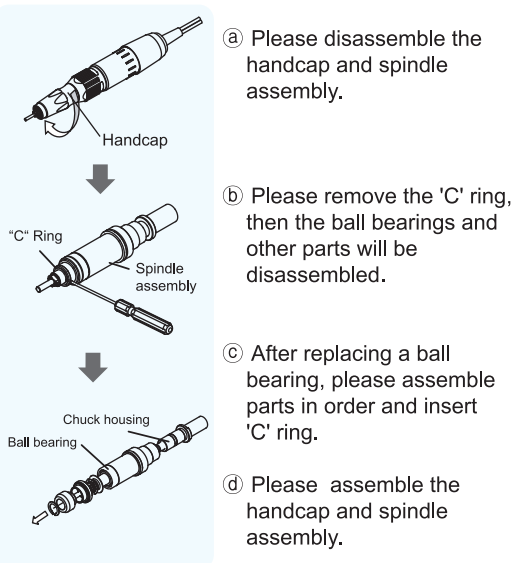

#### Notice

Please use the handpiece after checking the existence of disorder under idle.

※ The replacement period of Carbon brush is about 1 year, but it is flexible according to the workload.

## How to treat the handpiece.

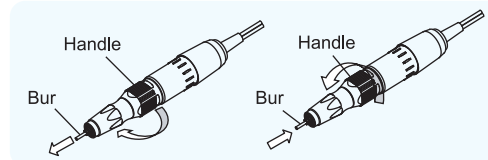

Please turn the handle to right-handed screw until sounding 'click', then replace the new 'Bur' and turn the handle to left-handed screw until sounding 'click' to lock the chuck.

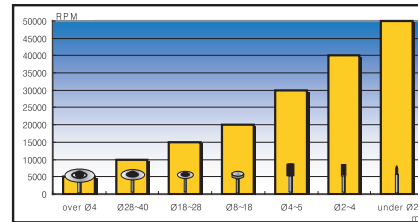

#### Notice

When using the bur, please observe the recommended rotation speed according to outer diameter.

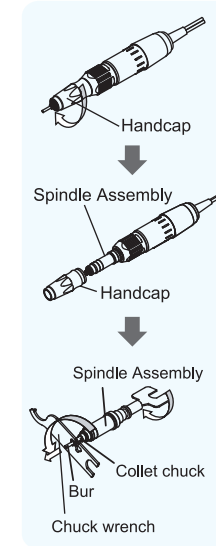

- Please turn the Handcap to left-handed screw and disassemble the handcap and spindle assembly.
- Please turn the chuck to left-handed screw with chuck wrench and chuck joint wrench to disassemble the bur and chuck.
- Please change to new chuck and assemble the handpiece.
- Please check it under idle after assembling and use it.

※ The life cycle of chuck is 2~3 years and it is flexible according to the workload.

## Trouble and Countermeasure

Problem	Check Point	Solution
Power Lamp is not lighten when turning on the power switch	Is the power cord plug connected well?	Please inset the plug of power cord in outlet correctly.
	Isn't the fuse broken?	Please replace it to designated fuse. If it goes on continuously, then ask repair.
	Trouble of power switch	Please ask repair
The motor does not work	Is the cord of motor connected well?	Please inset the motor cord in outlet correctly
	Isn't the chuck opened ?	Please lock the collect chuck by turning the handle to left-handed screw.
	Internal Circuit's problem in control unit	Please ask repair
	Have you used a handpiece for a long time under high-load ?	Turn off the control unit, please keep it at cool place for 10 minutes and work it.
Foot pedal does not work	Is the cord of foot pedal connected well?	Please inset the plug of foot pedal in outlet correctly on the rear.
	Isn't the Hand mode set up instead of Foot mode?	Please change to Foot mode by putting Hand/Foot mode button. Foot mode is a state that the LED is turned off.
The handpiece makes noise	Isn't foreign substance in a collect chuck?	Please remove it after disassembling the collect chuck. (Please refer to this instruction for use)
	Don't you use it at abnormal speed ?	Please adjust the RPM properly after referring to the permitted RPM for bur.
	Isn't the bur curved?	Please replace it with normal one .
Does the motor make noise continuously?		Please ask repair.

## Contact information

**MicronX**

■ Address : 22, Maeyeo-ro 1-gil, Dong-gu, Daegu, 41059 Republic of Korea

If you have a problem, please contact us to the following Telephone or E-mail.

### ■ Contact Information

Tel : +82-53-650-1000  
 Fax: +82-53-650-1001  
 E-mail: micronx@micronx.co.kr

### ■ Website

www.micronx.co.kr